

## Efficiency Tip 13014

# Close-up Views on Layout Sheets



This feature can be used to show a magnification of framing. The "Input Close-Up" command allows you to display an associated viewport as a "close-up" on the layout sheet. Possible uses:

- NextPhase Solutions to show framing connection
- Enlarge single units in a High Density Housing (HDH) plans
- Show detailed Cantilever Corner framing
- Enlarge framing around stairs opening

### Steps:

1. Complete your drawing as you normally would with layout sheets

**Note:** Layout sheet must be created before inserting the Close-Up or you will be adding steps to placement on the correct layout sheet.

2. In **Plan View** Select > **Text and Annotation** >  **Input Close-Up** 
3. In the properties grid select the **Associated Layout Sheet** that you want the Close-Up to be displayed on and set the **Width** and **Height**

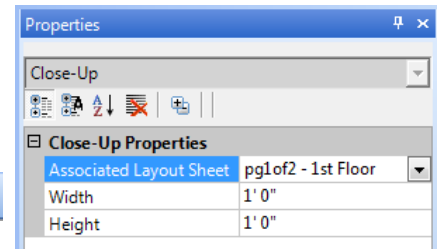

4. Insert the Close-Up (centre point) in the desire location on the plan. Place as many as desired, the command will remain active until you cancel [Esc]. If a Close-Up does not surround enough detail, select the green box and increase the **Width** and **Height** in the properties grid.

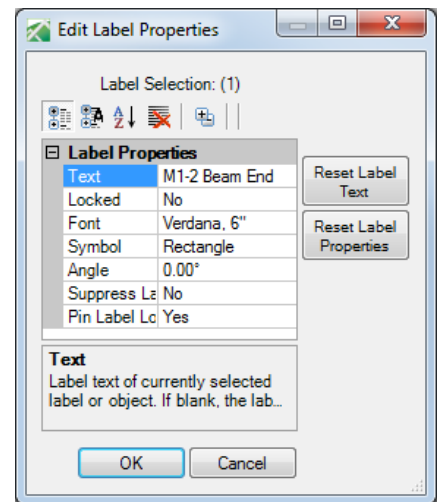
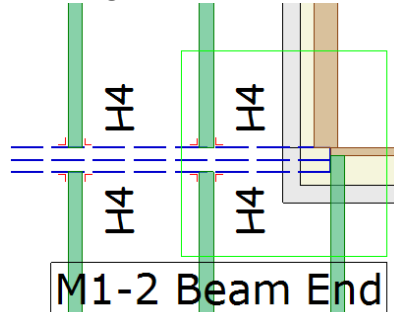

5. Default Label is **D1** and the number will increment as more Close-Ups are placed. These labels can be modified by selecting it and making the desired text change (**M1-2 Beam End**) in the Properties Grid, or by double clicking the label to display the Edit Label Properties dialog.
6. The Close-Up is placed left of the Layout Sheet by Default and can be dragged to desired location on the Layout Sheet.
7. Close-Up views have their own Visibility Switches, which can be controlled through the visibility window or schemes to display desired information.

### Schemes...

Setup > Schemes...

Job Settings > **Text and Annotation** define default box size.

**Visibilities Switches:**  
**Viewport Close-Up**

Define switches.

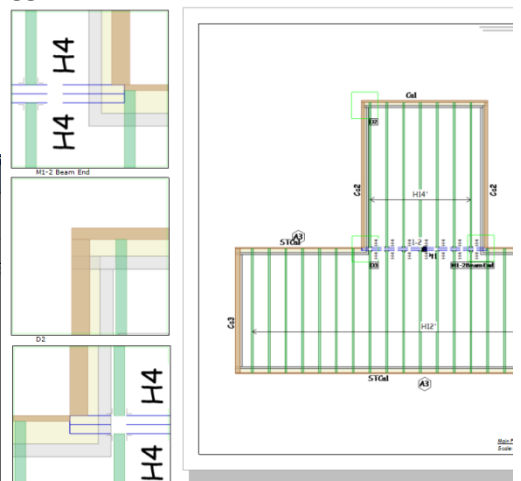
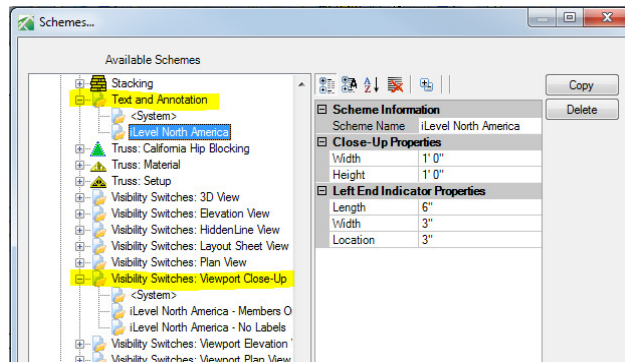

**Note:** If you create a new scheme or rename an existing scheme make sure to update your Template for new Javelin files. Existing file: Open Job Properties> select Job settings> pick your scheme (if the name has changed).